

# SALVATORI

DAL 1946

—

BATHROOMS 2016/2017

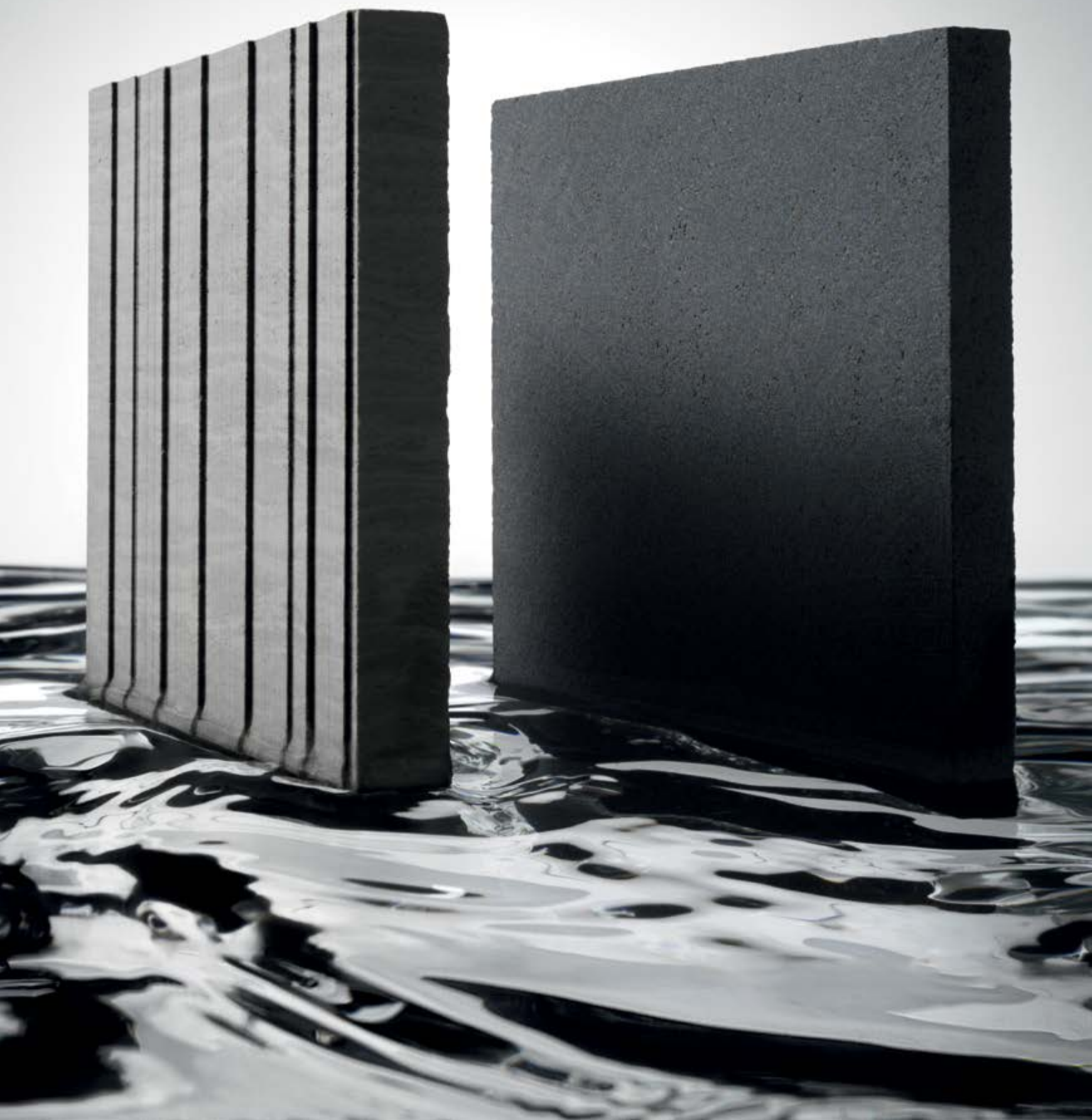



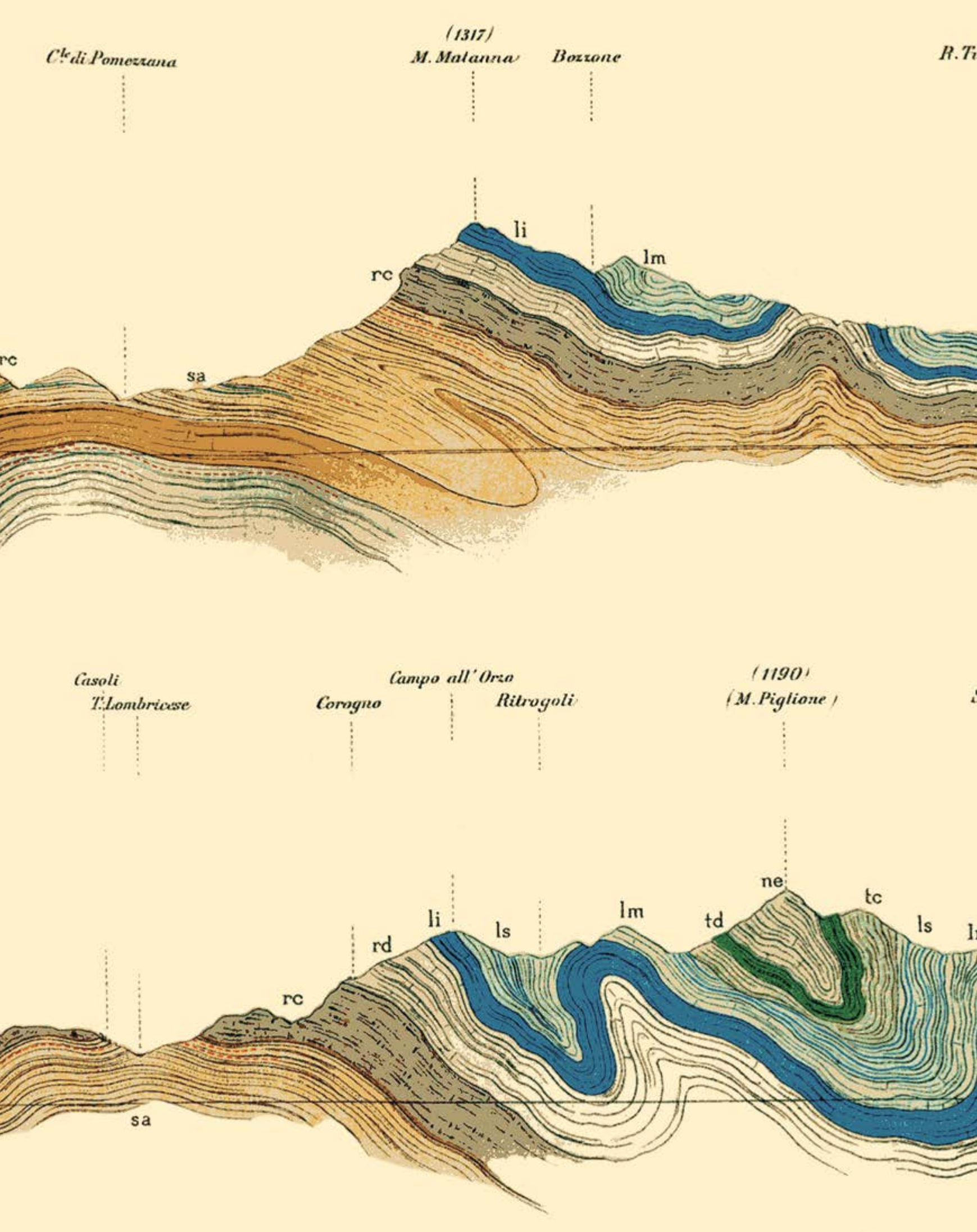

For over 70 years at Salvatori we have pushed the boundaries of stone, constantly experimenting with different ways to use it. From our earlier textures such as Dune and perennial favourite Bamboo, through to relative newcomers Raw and Romboo, we have sought to take the hardworking and enduring properties of stone and refine them in surprising and elegant ways.

We are now delighted to take that evolution one step further with our first ever catalogue devoted to the bathroom environment.

We have developed our bathroom collection with two clear objectives in mind.

Firstly, we have striven to eliminate as much as possible of the stress and work which often arise when it comes to installing stone features. Coordinating plumbers, builders and stone masons can be costly, time-consuming and energy-sapping, so our solution is a series of bathtubs, basins and showers which can be installed with a minimum of fuss.

This practical aspect aside, we have also focused on aesthetics and the idea of achieving a "total look" encompassing walls, floors, tubs, basins and shower trays. The result is a bathroom which goes beyond being merely functional and instead becomes a beautiful space in its own right.

I invite you to be as inspired by what can be achieved in stone as my family's company has been for over half a century.

Gabriele Salvatori  
Tuscany  
Italy

Salvatori è da oltre settant'anni un'azienda leader del settore della lavorazione della pietra, costantemente impegnata nella sperimentazione di soluzioni innovative per l'impiego di questo straordinario materiale. Dalle prime texture, come Dune e l'intramontabile e richiestissimo Bamboo, alle proposte più recenti come Raw e Romboo, il marchio Salvatori ha saputo sfruttare sapientemente la sua inesauribile robustezza sviluppando processi di lavorazione sempre più sofisticati per la realizzazione di soluzioni inedite, esclusive ed eleganti.

Oggi siamo lieti di proseguire in questo percorso di evoluzione presentando il primo catalogo dedicato all'ambiente bagno.

Abbiamo sviluppato la nostra collezione bagno perseguendo due chiari obiettivi. Innanzitutto abbiamo cercato di eliminare il più possibile lo stress ed il lavoro che spesso l'installazione dei prodotti in pietra comporta. Coordinare idraulici, muratori e marmisti può rivelarsi molto oneroso in termini di tempo, denaro ed energie, di conseguenza abbiamo pensato a soluzioni inedite, proponendo linee di vasche da bagno, lavabi e docce che si contraddistinguono per la facilità di installazione.

Oltre a questo aspetto pratico, abbiamo concentrato la nostra attenzione sul design nell'intento di ottenere un "total look" armonioso che comprendesse pareti, pavimenti, vasche da bagno, lavabi e piatti doccia, trasformando così l'ambiente bagno in uno spazio non solo funzionale, ma in un'esperienza da vivere in tutta la sua bellezza.

Il mio augurio è che riusciate a lasciarvi ispirare dalla pietra e da ciò che è possibile realizzare con questo materiale, esattamente come la mia famiglia ed io facciamo da oltre cinquant'anni.

Gabriele Salvatori  
Toscana  
Italia



salvatori.it

HEAD OFFICE  
SEDE CENTRALE  
Via Aurelia 395/E  
55047 Querceta (LU)  
ITALY  
Ph: +39 0584 769 200  
info@salvatori.it

SHOWROOMS  
Via Solferino 11  
Milan  
ITALY  
Ph: +39 02 8050 0372  
milano@salvatori.it

Hardturmstrasse 169  
Zurich  
SWITZERLAND  
Ph: +41 44 271 3702  
zurich@salvatori.it

26 Wigmore St  
London  
UNITED KINGDOM  
info@salvatoriuk.com

Level 1, 318 Liverpool Street  
Darlinghurst, Sydney  
AUSTRALIA  
Ph: +61 2 8521 5001  
info@savatori.com.au

For a complete and current list of stockists  
please contact sales@salvatori.it

Per un elenco completo ed aggiornato  
dei rivenditori, si prega di contattare  
sales@salvatori.it

CREDITS

Design and concept: Kuchar Swara  
Photography: Michael Bodiam, Robin Broadbent  
Daniele Scarpati, Dario Tettamanzi  
Styling: Elisa and Raffaella Ossino  
Illustrations: Louise Zergaeng Pomeroy  
Printing: Grafiche Mariano

THANKS TO

Laboratorio di Scultura Cervietti, Pietrasanta  
for generously allowing us access to their treasure  
trove of sculptures.

Nonna Lory in Pietrasanta for keeping us going  
with her wonderful cooking during the long days  
of shooting.

The Accademia di Belle Arti di Carrara for the  
stunning geological map of the Apuan Alps.

The entire team at Salvatori HQ who worked  
crazy hours and met seemingly impossible  
deadlines and logistical challenges to make  
this catalogue happen.

Special thanks to Fratelli Fantini S.p.A. for their  
beautiful taps and fittings.

Salvatori is proud to hold SCS certification for  
our product Lithoverde®.

RINGRAZIAMENTI

Design e concept: Kuchar Swara  
Fotografia: Michael Bodiam, Robin Broadbent  
Daniele Scarpati, Dario Tettamanzi  
Styling: Elisa e Raffaella Ossino  
Illustrazioni: Louise Zergaeng Pomeroy  
Stampa: Grafiche Mariano

SI RINGRAZIANO

Laboratorio di Scultura Cervietti, Pietrasanta per  
averci generosamente concesso l'accesso al loro  
autentico patrimonio di sculture.

Nonna Lory di Pietrasanta per avere allietato i  
nostri palati con la sua meravigliosa cucina durante  
i lunghi giorni delle riprese fotografiche.

L'Accademia di Belle Arti di Carrara per  
l'eccezionale mappa geologica delle Alpi Apuane.

L'intero team di Salvatori che ha lavorato  
incessantemente riuscendo a rispettare scadenze  
impossibili risolvendo enormi problemi logistici per  
consentire la realizzazione di questo catalogo.

Ringraziamenti speciali a Fratelli Fantini S.p.A.  
per la splendida linea di rubinetteria.

Siamo lieti di confermare che Lithoverde®  
è un prodotto certificato SCS.

The quarries. Where it all starts. Our headquarters  
are dominated by the Apuan Alps, home to the  
imposing Carrara quarries with their gleaming white  
gashes. For centuries man has hewn the marble  
from them, treasuring the stone for its qualities of  
permanence and endurance. With such a backdrop  
to our daily lives, it is little wonder that stone is  
embedded in our DNA, shaping all that we do.

Salvatori  
Stone innovation

Le cave: dove tutto ha inizio. Un tesoro da custodire  
gelosamente, con i suoi enormi squarci bianchi e  
luminosi. Dalla sua dura anima l'uomo ha attinto nei  
secoli ispirazione per opere immortali.  
La nostra sede: incastonata ai piedi delle Alpi  
Apuane, dal loro imponente sfondo ne trae la forza  
e l'energia. Circondati da un tale scenario, non  
sorprende che la pietra sia parte integrante del DNA  
Salvatori, protagonista di tutte le nostre creazioni.

Salvatori  
Innovazione nella pietra







ONSEN COLLECTION  
designed by  
Rodolfo Dordoni

BASIN  
Onsen in honed Pietra  
d'Avola with cabinet in  
lacquered wood  
BATHTUB  
Onsen in honed  
Pietra d'Avola  
SHOWER TRAY  
Filo in Pietra d'Avola Raw

SHOWER WALL  
AND FLOOR  
Sandblasted Pietra  
d'Avola  
REAR WALL  
Honed Pietra d'Avola  
MIRROR  
Onsen  
FOLDING STOOL  
Onsen in stainless steel  
with canvas seat



Onsen

SIZES  
Basin with cabinet unit:  
l120 × w40 × h55cm  
47¼ × 15¾ × 21⅝"  
  
Also available in  
pedestal version:  
l120 × w40 × h85cm  
47¼ × 15 × 33½"  
  
3D files available online

MATERIALS  
Crema d'Orcia  
Pietra d'Avola  
Silk Georgette  
White Carrara

TEXTURE  
Honed

SIZE  
Bathtub  
l180 × w80 × h53.5cm  
70⅞ × 31½ × 21⅞"

MATERIALS  
Crema d'Orcia  
Pietra d'Avola  
Silk Georgette  
White Carrara

TEXTURE  
Honed

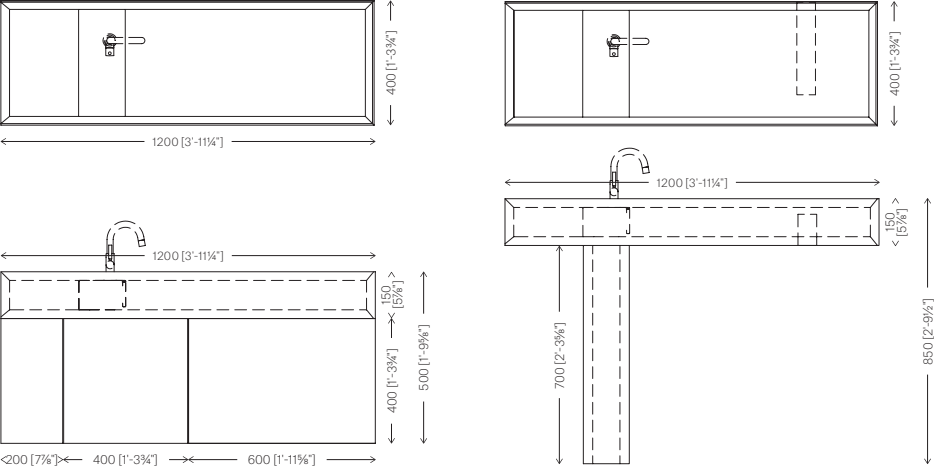
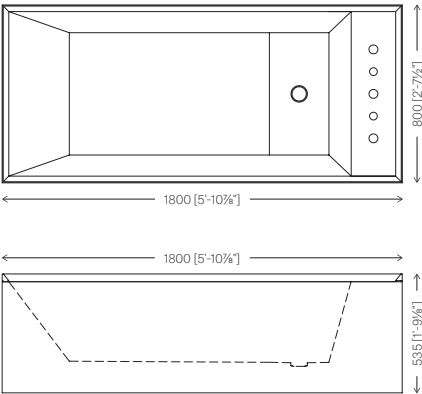





SHOWER TRAYS  
Filo, in both flush  
and raised version  
Pietra d'Avola Raw  
FLOOR  
Honed Pietra d'Avola



SHOWER TRAY  
FILO 4 | 100  
in Pietra d'Avola  
REAR WALL  
Pietra d'Avola Raw  
LEFT WALL  
AND FLOOR  
Honed Pietra d'Avola  
TABLE  
Dritto designed by  
Piero Lissoni  
and Salvatori



Sketches are for illustrative purposes only

# Filo

A practical and supremely simple-to-install shower tray, Filo provides the finishing touch to a seamless Total Look bathroom. No carpenters, no stone cutters involved, it comes ready for a plumber to install with the minimum of fuss, thereby reducing time, cost and the stress of coordinating tradespeople. Available in both flush and raised versions.

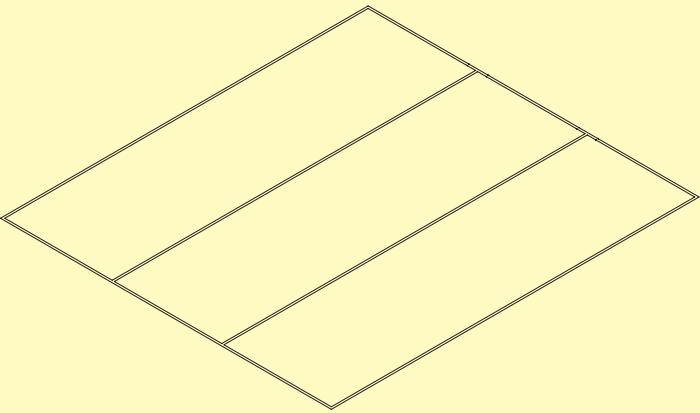

## Flush Version Specifications

MATERIALS Crema d'Orcia Gris du Marais Lava Pietra d'Avola Piombo Silk Georgette Bianco Carrara Other stones upon request	TEXTURES Bamboo Cotone Raw Sandblasted Other textures upon request
---	---

## Easy Installation

Prepare your mortar bed in the usual way.

STEP 1  
Position the stainless steel tray.

STEP 2  
Connect the waste.

STEP 3  
Lay the slats onto the tray.

## Sizes

FILO 3   80 90 × 80cm 35½ × 31½"	FILO 4   80 119.8 × 80cm 47¼ × 31½"	FILO 5   80 149.6 × 80cm 58⅞ × 31½"	FILO 3   100 90 × 100cm 35½ × 39⅝"	FILO 4   100* 119.8 × 100cm 47¼ × 39⅝"	FILO 5   100* 149.6 × 100cm 58⅞ × 39⅝"

\*ADA-compliant for transfer shower cubicles. We also produce an ADA-compliant shower tray for roll-in units. Size: 76.2 × 152.4cm (30 × 60"). Consists of 5 slats with an enhanced thickness of 3cm (1¼").



Complete Kit

Every Filo shower tray comes complete with a self-cleaning waste for instant attachment to existing systems and a stainless steel tray edged with rubber to minimise noise and slippage. Included in the kit are silicone sealant, rubber strips and a customised lever for raising the slats when particularly thorough cleaning is required. The flush version also contains height-adjustable feet.

Total Look

Available in six different stones and three finishes, Filo can be combined with stone surfaces to create a seamless bathroom environment.

Raised Version Specifications

**MATERIALS**  
Crema d’Orcia  
Gris du Marais  
Lava  
Pietra d’Avola  
Piombo  
Silk Georgette  
Bianco Carrara  
Other stones upon request

**TEXTURES**  
Bamboo  
Cotone  
Raw  
Sandblasted  
Other textures upon request

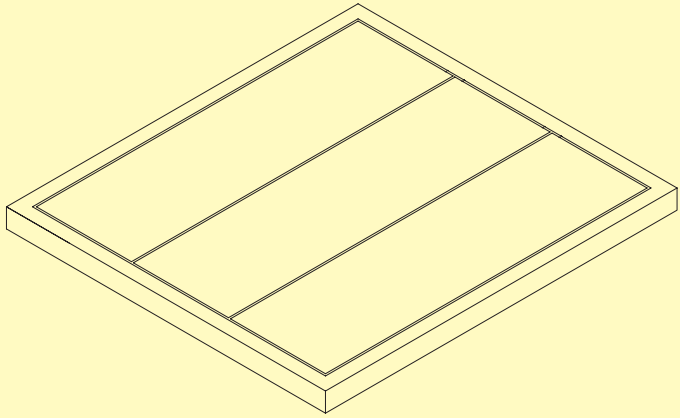

Easy Maintenance

For the stone slats we recommend a neutral cleaner diluted in water as per the care instructions included in the installation guide. The stainless steel tray requires only occasional cleaning using standard household products and is easily done. Simply remove the central slat using the customised lever provided, and clean in the normal way.

Easy Installation

Prepare the ground in the normal manner, paving or covering the floor.

**STEP 1**  
Insert the waste provided in the Filo kit over the hole and connect to the existing pipe system.

**STEP 2**  
Place the steel tray over the waste.

**STEP 3**  
Lay the slats onto the tray.

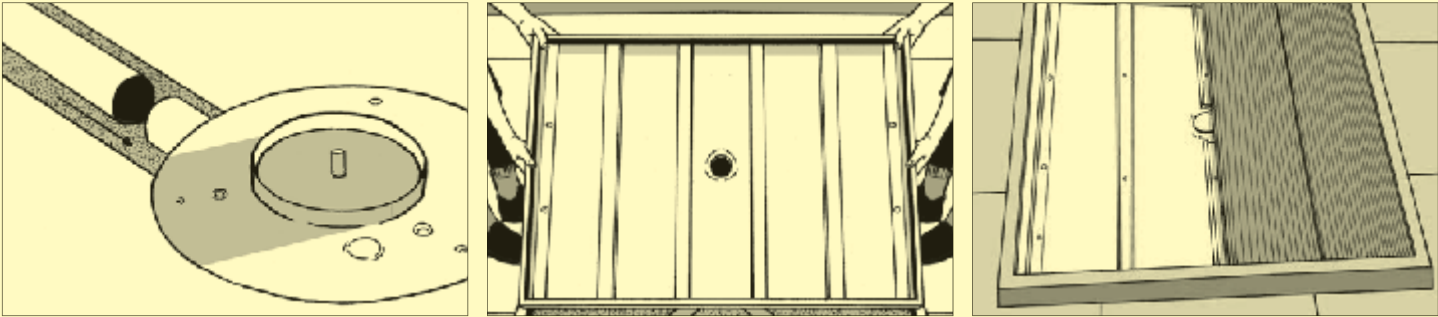

Sketches are for illustrative purposes only

Sizes

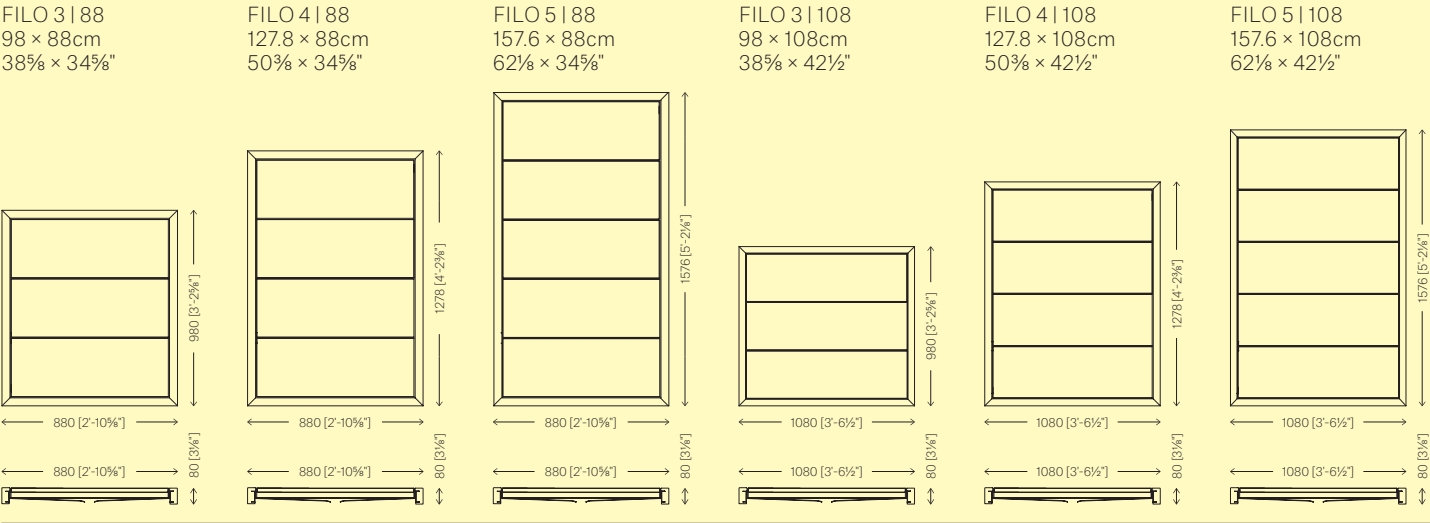

3D files available online

SHOWER TRAY  
FILO 5 | 108 in  
sandblasted Piombo  
WALL  
Heavily sandblasted  
Piombo  
FLOOR  
Sandblasted Piombo





SHOWER TRAY  
Filo flush version  
Sandblasted Lava  
FLOOR  
Sandblasted Lava







SHOWER TRAYS  
Filo, in both flush  
and raised version  
Crema d'Orcia Raw  
FLOOR  
Honed Crema d'Orcia





SHOWER TRAY  
Filo flush version  
White Carrara Bamboo  
FLOOR  
Honed White Carrara



SHOWER TRAY  
Filo flush version  
Pietra d'Avola Bamboo  
FLOOR  
Honed Pietra d'Avola







SHOWER TRAY  
Filo flush version  
Silk Georgette Bamboo  
FLOOR  
Honed Silk Georgette



BATHTUB  
Ishiburo by  
Kengo Kuma in  
Crema d’Orcia  
WALLS AND FLOOR  
Honed Crema d’Orcia



# Ishiburo

*Ishiburo* represents the very first complete product line ever created by renowned architect and designer Kengo Kuma. As an ardent lover of stone, he specifically selected Crema d’Orcia, exclusive to Salvatori, for its properties of light and warmth. The collection comprises bath, basin and shower tray with wall finish.

## The Designer

Kengo Kuma is an award-winning Japanese designer and architect among whose major works are Kiro-san Observatory, Water/Glass, Museum of Art in Tokyo and Bamboo Wall House in China. In 2009 he was made an Officier de L’Ordre des Arts et des Lettres in France and recently MOMA New York and Centre Pompidou acquired models and drawings of his major works for their permanent collection.

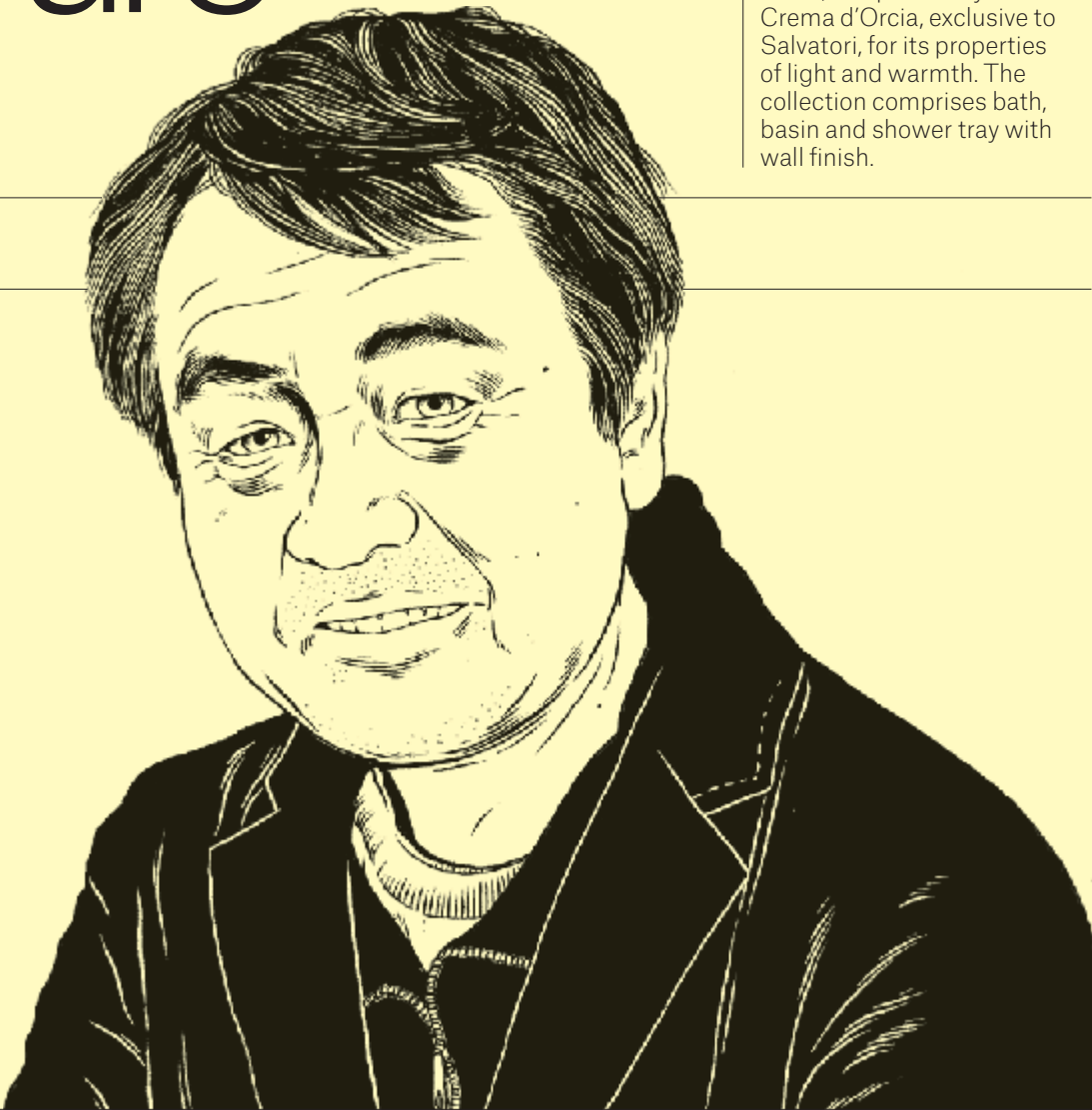

## Bath

SIZE  
l203.5 × w100 × h55cm  
80⅛ × 39⅜ × 21⅞"

MATERIALS  
Crema d’Orcia  
Pietra d’Avola  
Silk Georgette  
Bianco Carrara

FEATURES  
A stone tub with a lightened structure containing an overflow and pop-up drain finished in matching stone.

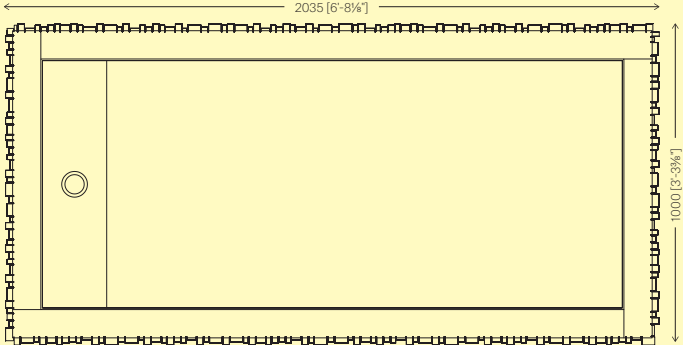
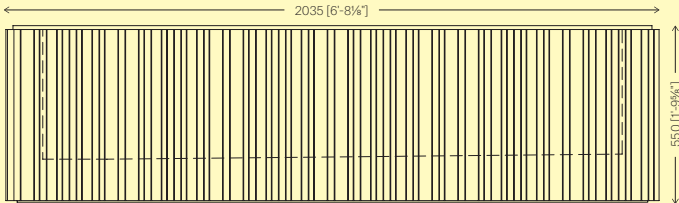



Basin

SIZE 182.2 × w48.3 × h85cm 32⅝ × 19 × 33½"	MATERIALS Crema d'Orcia Pietra d'Avola Silk Georgette Bianco Carrara	FEATURES With one side of the basin tilted, the water washes away gently and discreetly, with no plughole or waste system visible.	
--	--	--	--

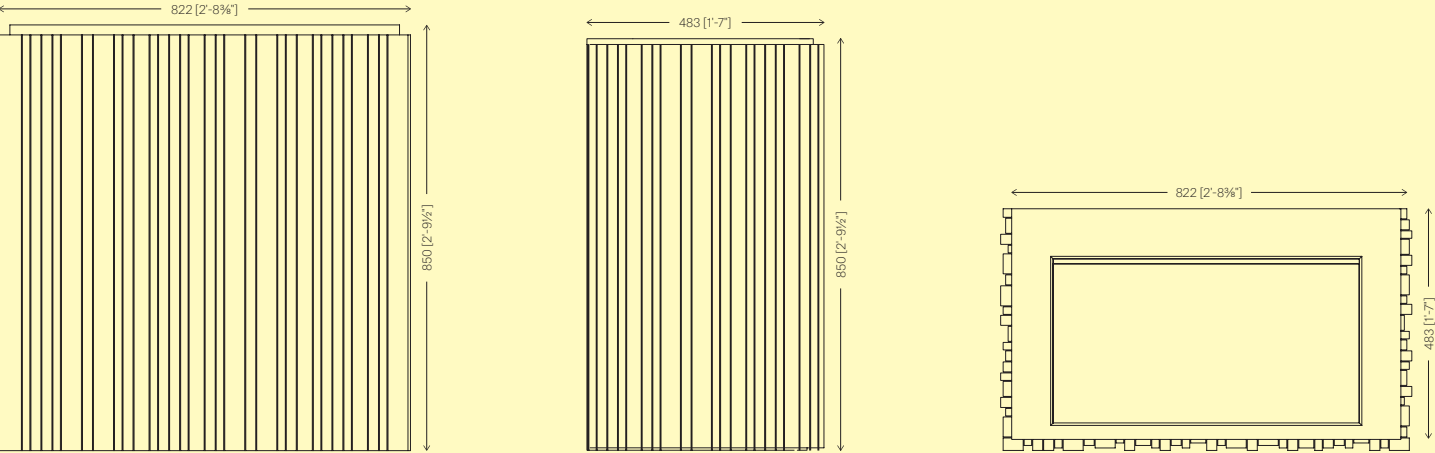

Shower Tray

SIZE 1157.6 × w108 × h8cm 62 × 42½ × 3⅛"	FEATURES Recycled teak slats laid over a stainless steel tray and encased in a stone frame
--	---

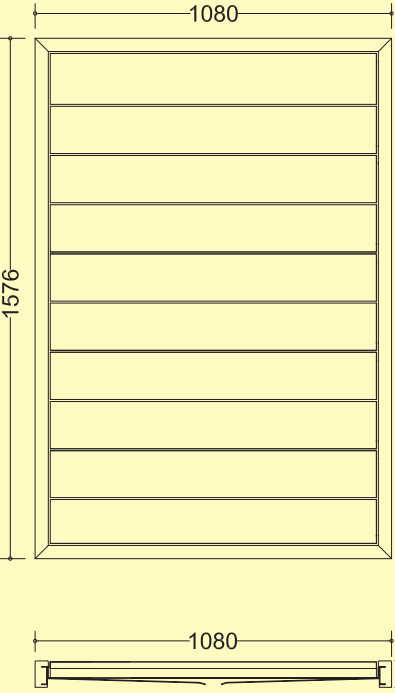

Shower Wall

SIZE Available in preassembled panels measuring 30.5 × 61cm 12⅝ × 24"	MATERIALS Crema d'Orcia Pietra d'Avola Silk Georgette Bianco Carrara
---	--

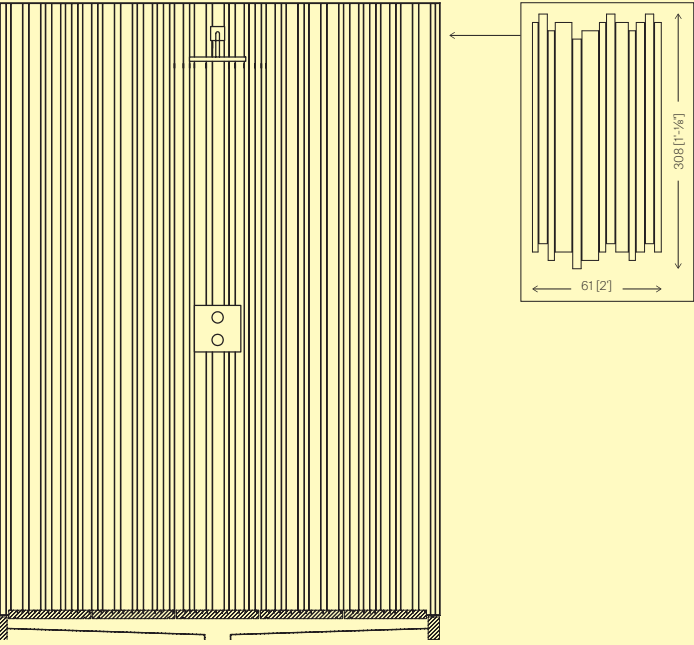

BASIN  
Ishiburo by Kengo  
Kuma in Crema d'Orcia  
SHOWER TRAY  
Ishiburo in  
Crema d'Orcia and  
reclaimed teak  
SHOWER WALL  
Ishiburo in Crema  
d'Orcia  
WALLS AND FLOOR  
Honed Crema d'Orcia











BASIN  
Stiletto 180 in honed  
Silk Georgette  
REAR WALL  
Silk Georgette  
Romboo  
RIGHT WALL  
AND FLOOR  
Honed Silk Georgette

# Stiletto

A simple-to-install washbasin with clean and simple lines, Stiletto combines practicality and aesthetics, blending seamlessly with stone walls and flooring for a Total Look bathroom. No carpenters, no stone cutters required, it comes complete with wall brackets for immediate installation. Taps can be deck- or wall-mounted according to preference.

## Specifications

MATERIALS  
Crema d'Orcia  
Gris du Marais  
Lava  
Pietra d'Avola  
Silk Georgette  
Bianco Carrara  
Other stones upon request

TEXTURES  
Honed  
Brushed sandblasted (lava only)

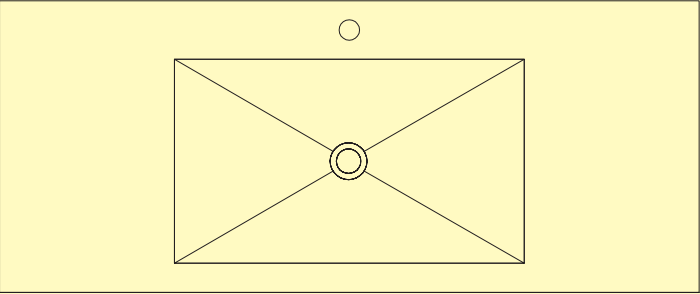

## Easy Installation

STEP 1  
Attach the two brackets supplied in the Stiletto kit to the wall.

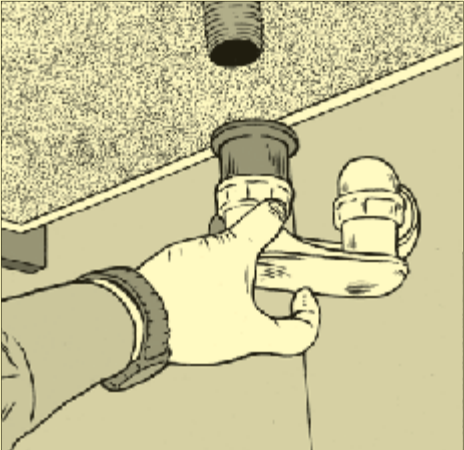
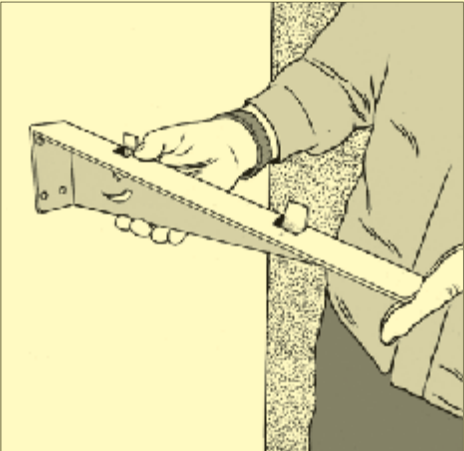

STEP 2  
Place the basin onto the brackets.

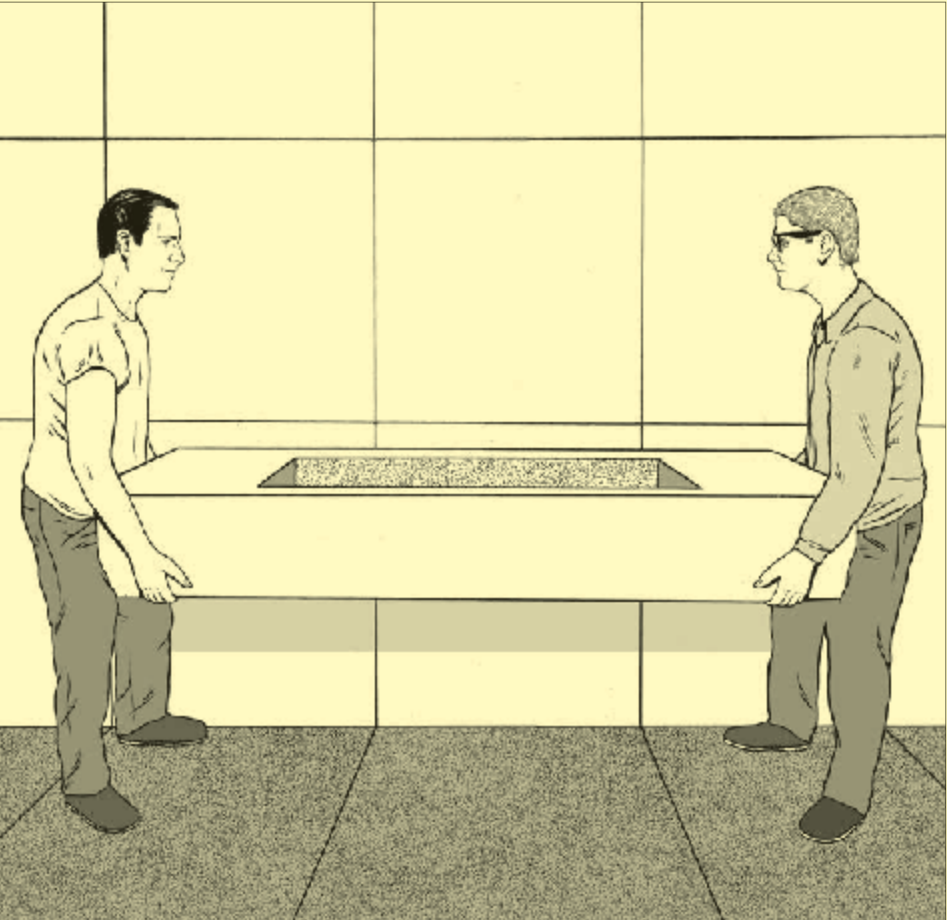

STEP 3  
Connect the pipe.

Sketches are for illustrative purposes only



Complete Kit

Every Stiletto basin comes complete with a stone-covered high-flow waste, two wall brackets, high-performance Fischer screws, corresponding drill bit and spanner along with a template to aid alignment when drilling holes.

Total Look

Available in five different stones and four lengths, Stiletto can be combined with stone surfaces to create a seamless and harmonious bathroom environment.

Easy Maintenance

We recommend a neutral cleaner diluted in water as per the care instructions included in the installation guide.

Sizes

STILETTO 90  
l90 × w50 × h30cm  
35½ × 19¼ × 11⅞"

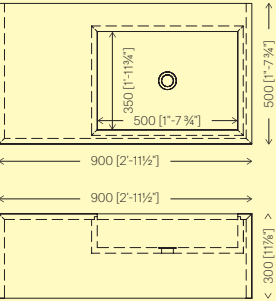

STILETTO 120  
l120 × w50 × h30cm  
47¼ × 19¼ × 11⅞"

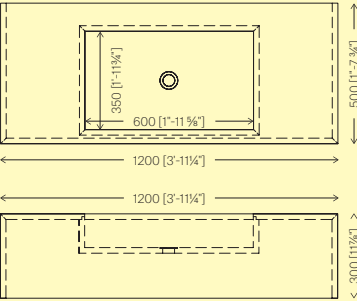

STILETTO 150  
l150 × w50 × h30cm  
59⅞ × 19¼ × 11⅞"

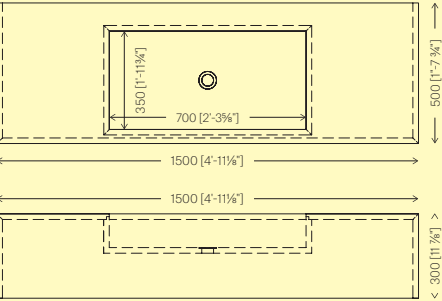

STILETTO 180  
l180 × w50 × h30cm  
70⅞ × 19¼ × 11⅞"

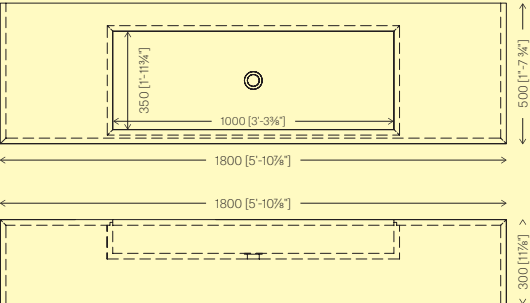

BASIN  
Stiletto 180 in brushed  
sandblasted Lava  
WALL AND FLOOR  
Brushed sandblasted Lava





Stiletto





Small Basins

MATERIALS  
Crema d'Orcia  
Light Travertine  
Pietra d'Avola  
Silk Georgette  
White Carrara



Pozzo  
Ø46 × h20cm  
18⅞ × 7⅞"

Zuppiera  
Ø40 × h15cm  
15¾ × 5⅞"

Bacinella  
Ø40 × h15cm  
15¾ × 5⅞"

Uovo  
Ø41.4 × h26.5cm  
Ø16¼ × 10½"



Ninfa

SIZES  
180 × w45 × h90cm  
31½ × 17¾ × 35½"

MATERIALS  
Crema d'Orcia  
Gris du Marais  
Pietra d'Avola  
White Carrara

TEXTURE  
Honed



FONTANE BIANCHE  
COLLECTION  
designed by  
Elisa Ossino  
BASIN  
Ninfa in Bianco Carrara  
SHELVES  
Ciane in honed Bianco  
Carrara

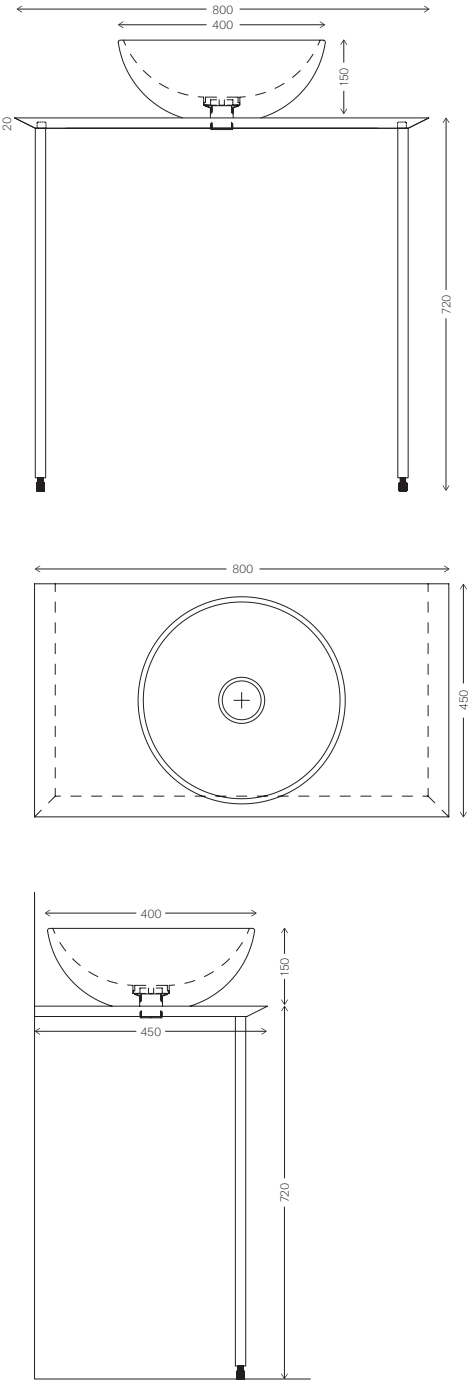

FONTANE BIANCHE  
COLLECTION  
designed by  
Elisa Ossino  
BASIN  
Ninfa in honed  
Gris du Marais  
WALL  
Gris du Marais  
Lithoverde®  
FLOOR  
Honed Gris du Marais





FONTANE BIANCHE  
COLLECTION  
designed by  
Elisa Ossino  
BASIN  
Alfeo in honed  
Bianco Carrara  
WALL  
Cotone Tratti  
in Bianco Carrara

Alfeo

SIZES  
l45 × w45 × h20cm  
17¾ × 17¾ × 7⅞"

MATERIALS  
Crema d'Orcia  
Gris du Marais  
Pietra d'Avola  
White Carrara

TEXTURE  
Honed

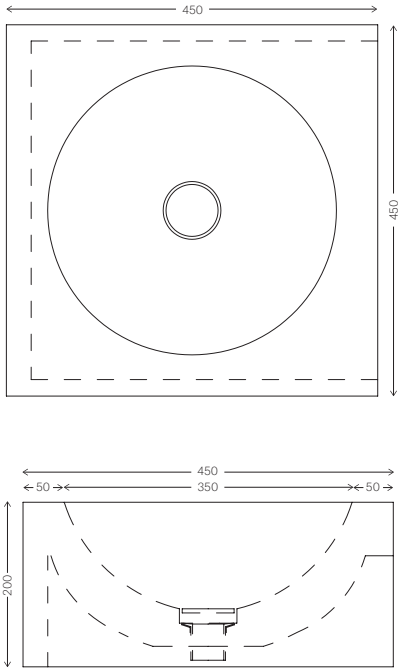



Ciane Modular Drawer

SIZES  
l45 × w60 × h20cm  
17¾ × 23 ⅝ × 7 ⅞"  
Also available in length  
90cm (35½")

The Ciane drawers  
can be combined with  
the Alfeo basin or  
installed separately.

MATERIALS  
Crema d'Orcia  
Gris du Marais  
Pietra d'Avola  
White Carrara

TEXTURE  
Honed

FONTANE BIANCHE  
COLLECTION  
designed by  
Elisa Ossino  
BASIN  
Alfeo in honed Crema  
d'Orcia  
DRAWERS  
Ciane in honed Crema  
d'Orcia  
REAR WALL  
Crema d'Orcia Bamboo  
SIDE WALLS AND  
FLOOR  
Honed Crema d'Orcia  
MIRROR  
Archimede

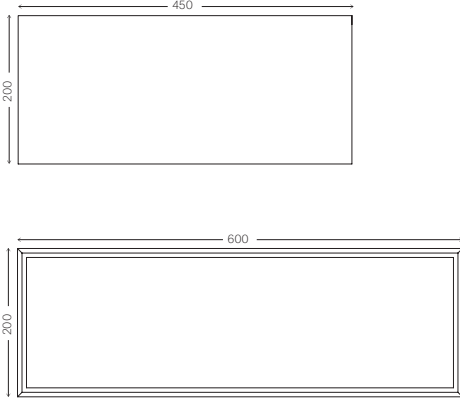





BATH  
Oyster in Crema d'Orcia  
REAR WALL  
Crema d'Orcia Raw  
SIDE WALLS  
AND FLOOR  
Honed Crema d'Orcia



Oyster

SIZE  
l180 × w80 × h51.5cm  
70⅞ × 31½ × 20¼"

3D files available online

MATERIALS  
Crema d'Orcia  
Gris du Marais  
Pietra d'Avola  
Silk Georgette  
White Carrara

TEXTURES  
Bamboo  
Honed  
Infinito  
Raw

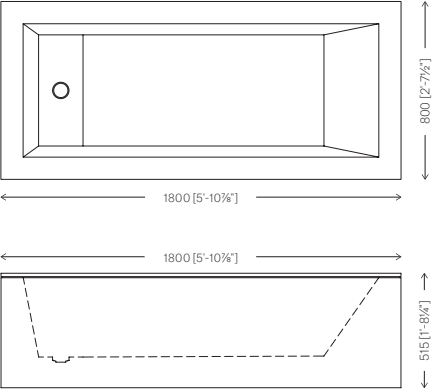

# CASE STUDIES

1 Armani Hotel  
Milan

2 Miraval Living  
New York

3 Residence  
Moscow





CLIENT  
Armani Hotel Milan

DESIGNER  
Armani Design Team

PROJECT DESCRIPTION  
Sourcing "the perfect stone" for the bathrooms of the Armani Hotel in Milan.

CHALLENGE  
Giorgio Armani had a very particular vision of how he wanted the bathrooms of his hotel to look: a stone that was not only timeless but at the same time contemporary and in line with his colour palette of elegant muted greys and beiges.

#### SOLUTION

1. In our quest for the ideal stone, we ended up in a tiny village on the Burmese border, reachable only by means of a 12-hour drive from the nearest airport.
2. Here, in a quarry literally in the middle of nowhere, we discovered the stone we called Silk Georgette and with which Giorgio Armani fell in love, describing it as his perfect "greige".

In fact, so delighted was he to have finally found a stone which encapsulated his vision, that he decided not only to use it for the floors and walls, but also for the cabinets.  
(continued overleaf)







3

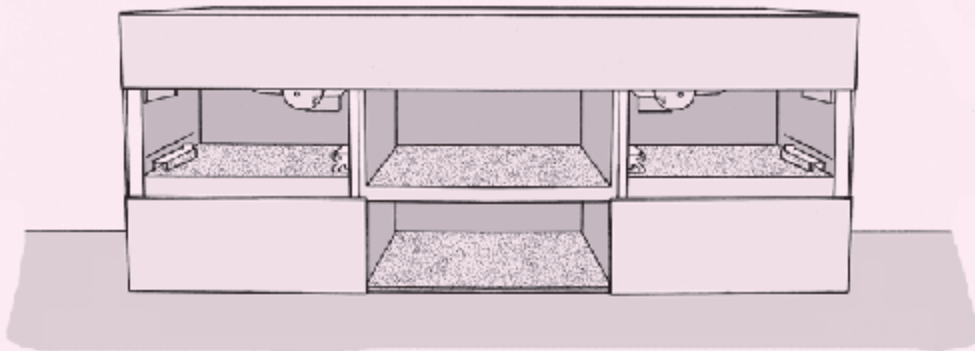

4

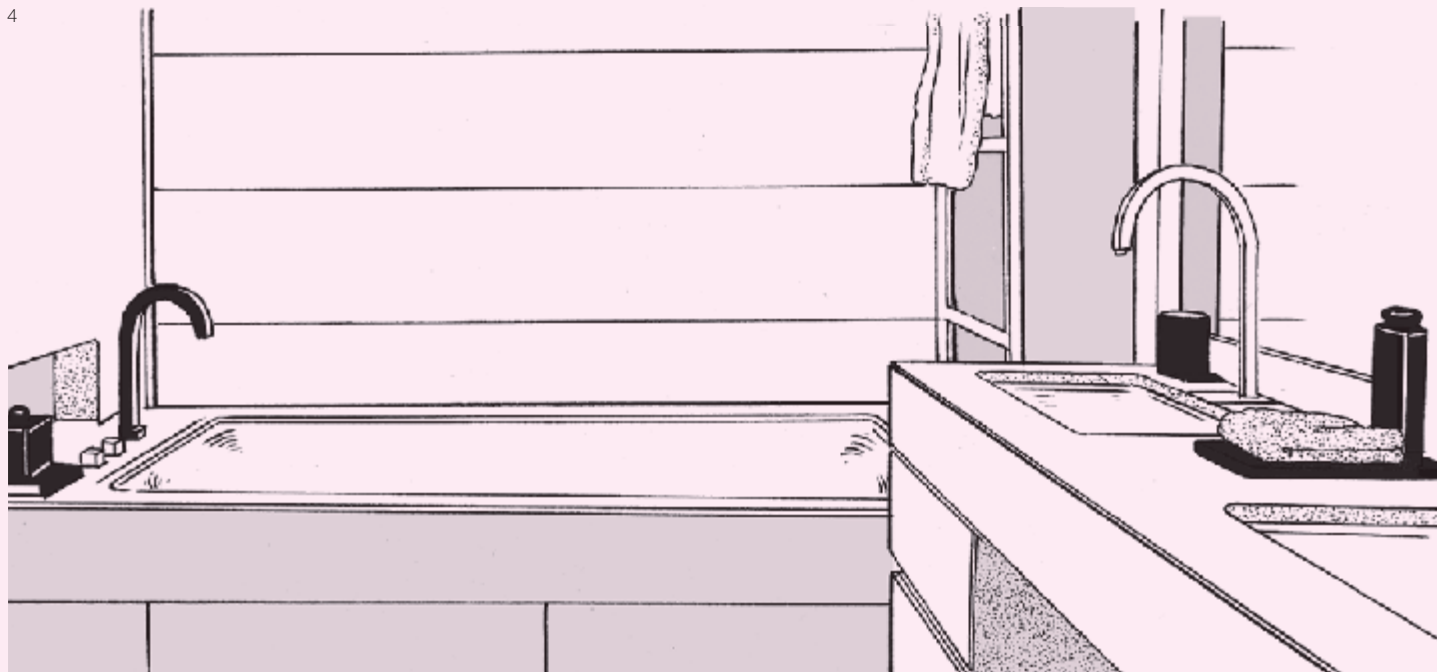

3. This, however, posed another challenge. Using stone for cabinets in a private bathroom is one thing, but the potential heavy workload in a hotel meant that we had to consider the amount of stress each cabinet would be subjected to. Working with designers and joiners, we developed a system with modular pieces all shaved to a thickness of less than 10mm. We then attached the stone to a wooden structure.

#### RESULT

4. The cabinets looked as though they had been created from one single block of stone, yet were light enough to ensure the drawers would move smoothly and that the cabinet would stand up to the rigours of hotel life.

And, because only Silk Georgette had been used for the floors, walls and the cabinets themselves, the overall effect was truly a "total Armani look".

# 2

CLIENT  
Miraval Living, New York

DESIGNER  
Bonetti & Kozerski Studio New York

PROJECT DESCRIPTION  
Providing the stone for the bathroom walls and floors of over 800 apartments in a residential development in Manhattan's Upper East Side.

CHALLENGE  
The architects wanted a combination of Crema d'Orcia and Piombo, both potentially susceptible to the humid conditions a bathroom environment creates. How to eliminate the high likelihood of mould developing without damaging the stone?

SOLUTION  
1. We carried out a thorough analysis of the environmental conditions, the composition of the stone and its reactive properties.  
2. We then developed a combination of treatments which, used together, eradicated the formation of mould and, importantly, could be replicated and applied on an industrial scale across 16,000 square metres of stone.  
*(continued overleaf)*

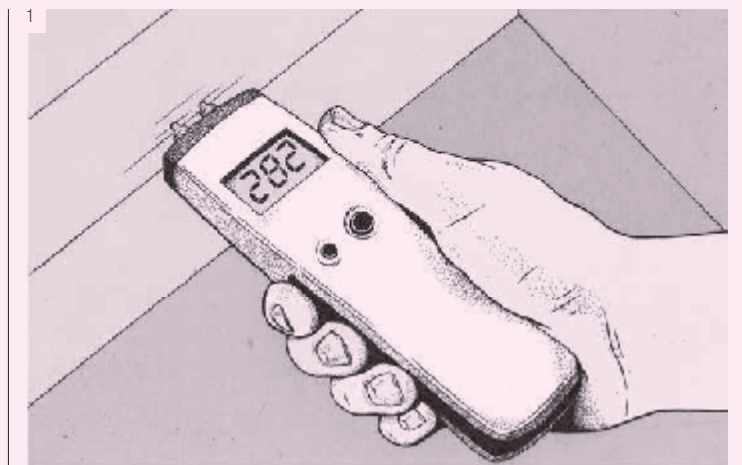

2

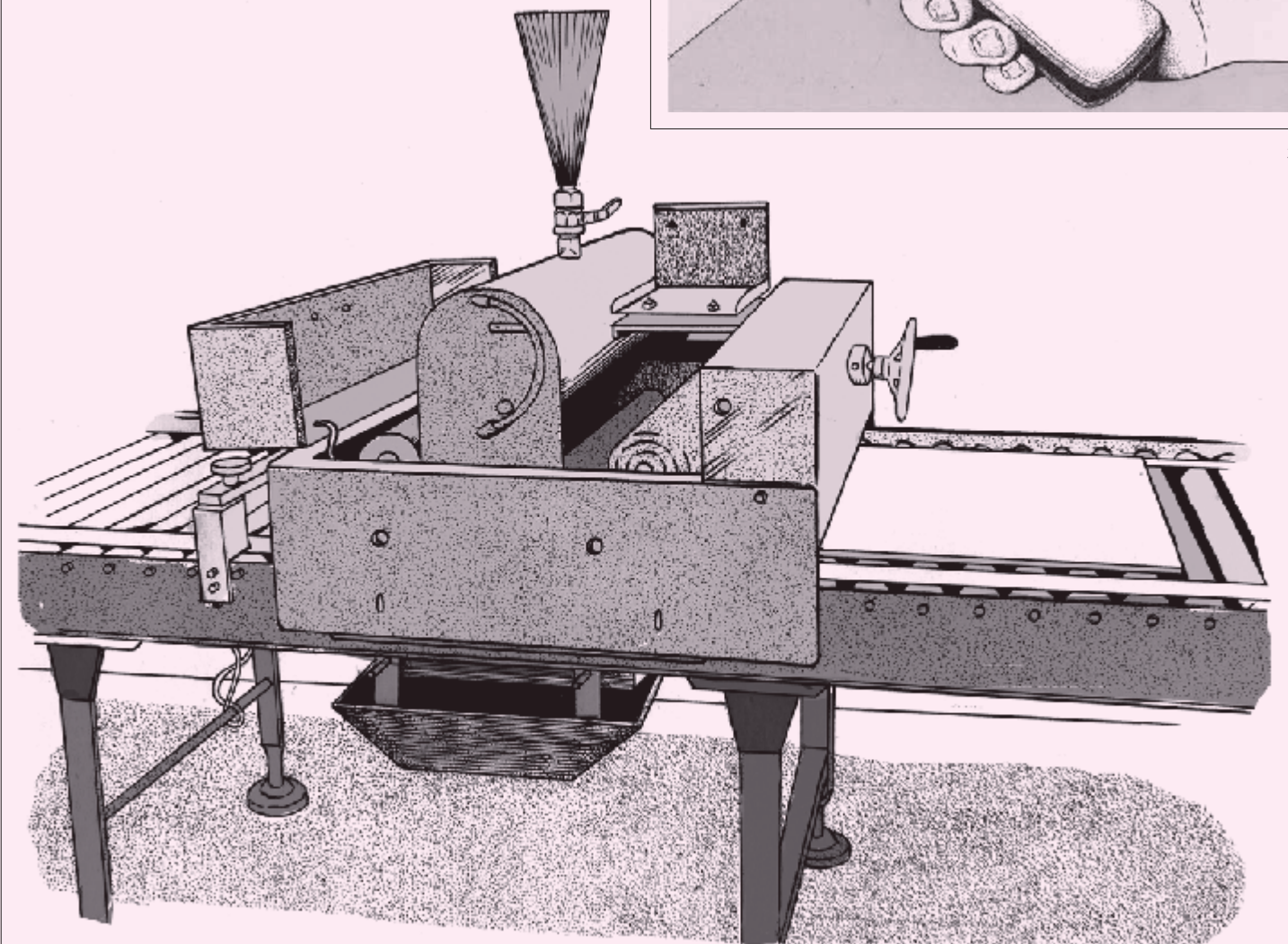



Now, having found a solution to treat the stone, there remained “only” the challenge of transporting huge amounts of it across 40 floors and 800 apartments with limited access due to the size of the existing elevators and structure itself.

3. We measured, we weighed, we examined and finally we developed packaging which had a two-fold benefit. Not only could the pieces be easily transported, but they were also complete kits which could be allocated on an apartment by apartment basis meaning less time and effort relocating pieces around the site.

**RESULT**  
800 apartments with bathrooms that not only looked great but were protected from the notorious local mould.

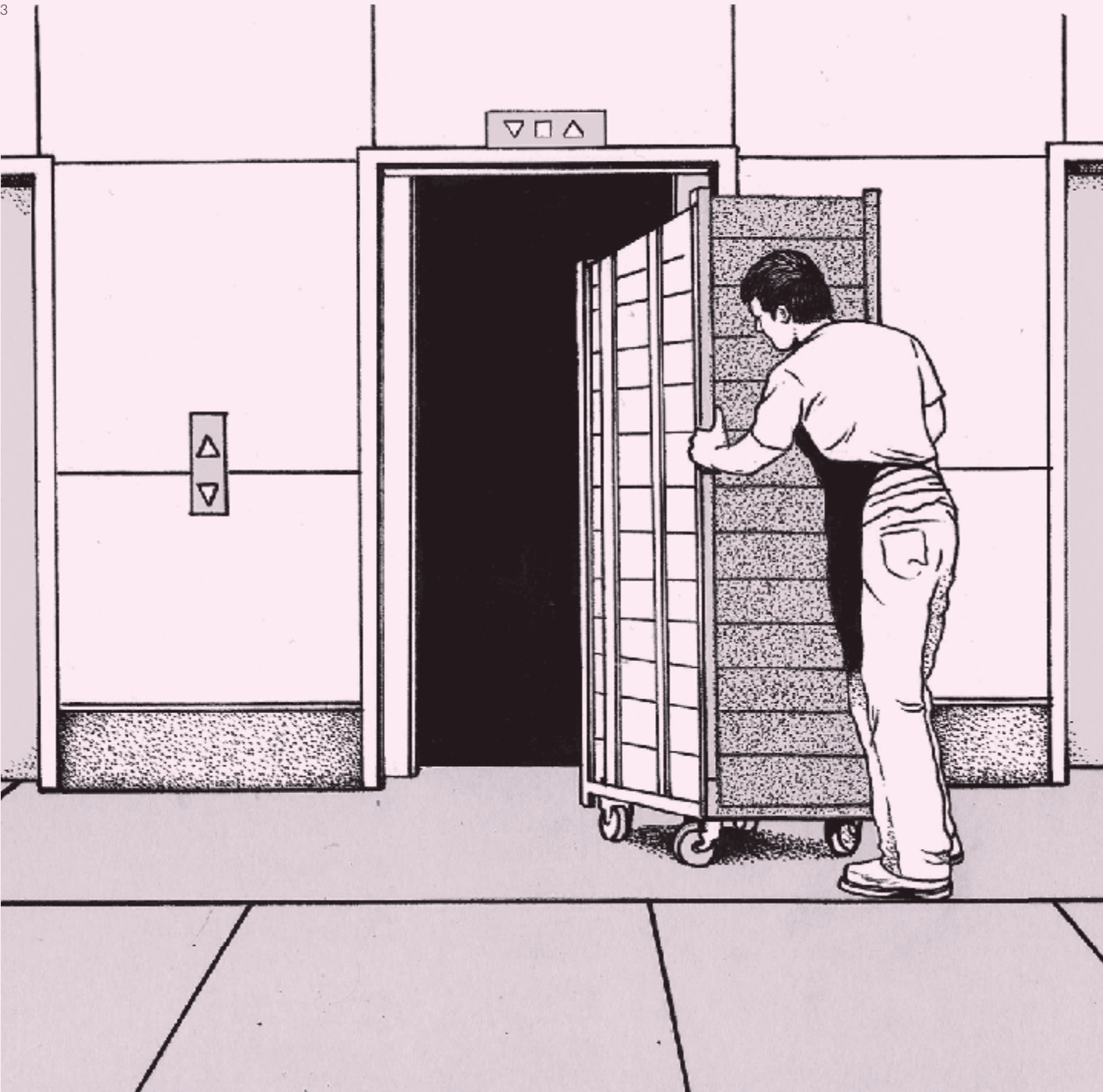

3

3

**CLIENT**  
Moscow Villa

**PROJECT DESCRIPTION**

We were initially asked to do the bathrooms for a villa in Moscow’s prestigious Rublevka area.

1. During the early consultation process, the design team showed us a very specific reference which the client had wanted to use as the basis of the design for the entire house but had been deemed too difficult. This reference was an ancient Persian carpet.

We suggested a way to recreate this in stone and as a result, they commissioned us not only to do the bathrooms, but also the interiors of the entire villa.

One of the elements was a vast staircase that was to be the centrepiece of the main hall and which had to blend with the key flower motif.

2. We carried out a “test run” and assembled both the staircase and entire floor in our workshop.

Satisfied that it worked perfectly, we numbered every piece and shipped everything, accompanied by an installation guide. We also sent one of our own team to oversee the local team during installation.

3. The final result was a villa with an imposing staircase and a central pattern that reflected the client’s vision which had all begun with inspiration from a Persian rug.



1

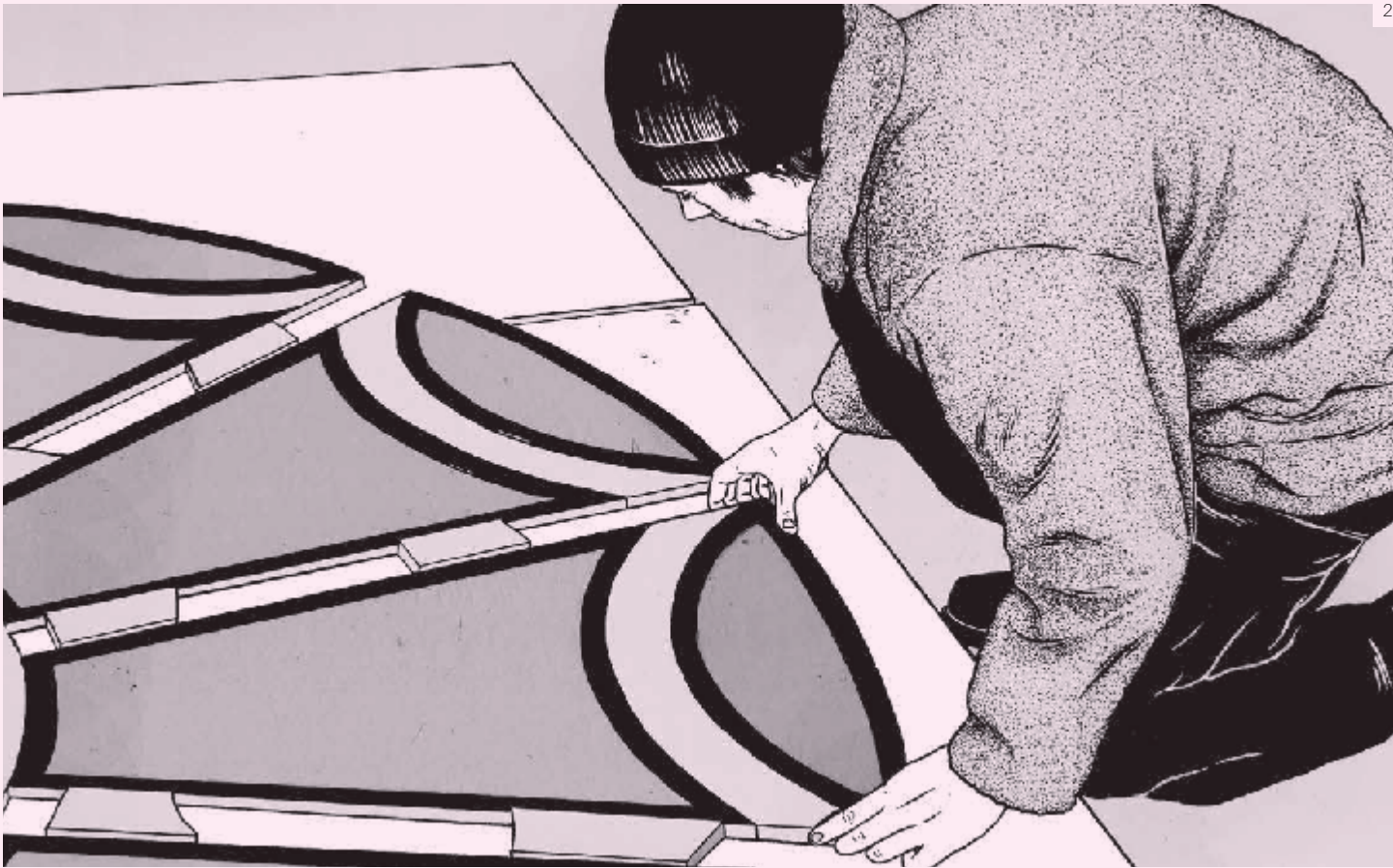

2



3



How To Look After Your Salvatori Bathroom

Caring for shower trays, basins and baths made from stone generally requires no more effort than for those manufactured from porcelain or plastic. The key, as for other materials, is to clean regularly so that soap scum, lime scale and the like do not have the chance to build up and congeal as that is when it becomes difficult to remove completely.

Stone floors and walls simply need to be wiped down using a neutral cleaner. One of the great properties of stone is that it stands up to hard wear and tear, so if you have grooved surfaces such as our Bamboo or Raw textures, you can use a scrubbing brush without fear of causing damage.

For occasional more intensive cleaning such as the removal of hair from the plug hole, the slats of the Filo shower tray can be easily lifted using the customised lever provided.

And to really ensure you keep your stone looking beautiful for years, we strongly recommend that you do not use cleaners containing abrasive cleansers, ammonia, bleach, acid or other strong solvents. Even those trusty “homemade remedies” made from lemon, vinegar, baking soda and the like should be avoided.

Every bathtub, basin and shower tray that leaves Salvatori is treated with a protective sealer designed to repel water and oil-based stains.

For any other questions you may have please feel free to email our Customer Care team at [customer care@salvatori.it](mailto:customer care@salvatori.it).

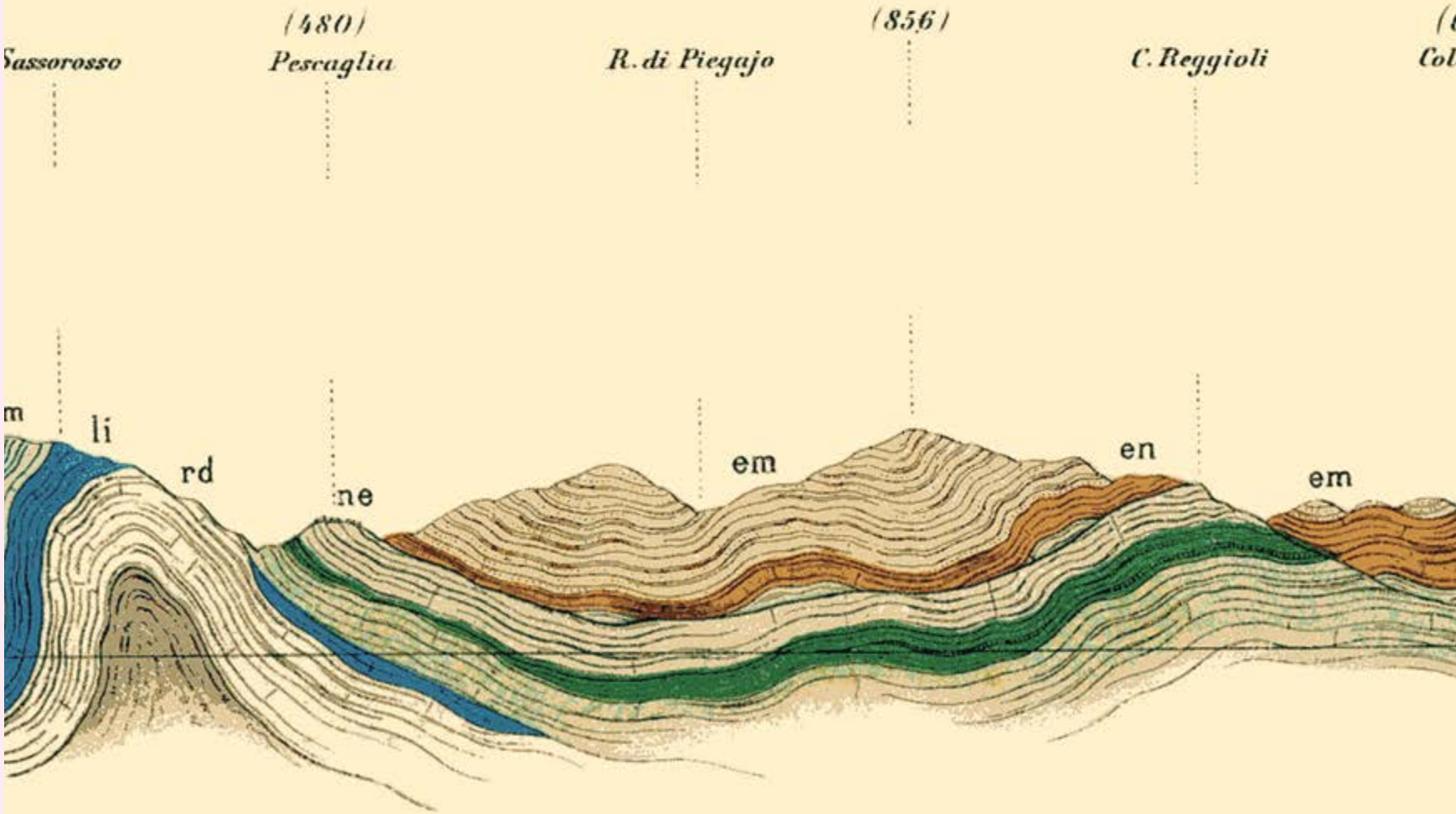
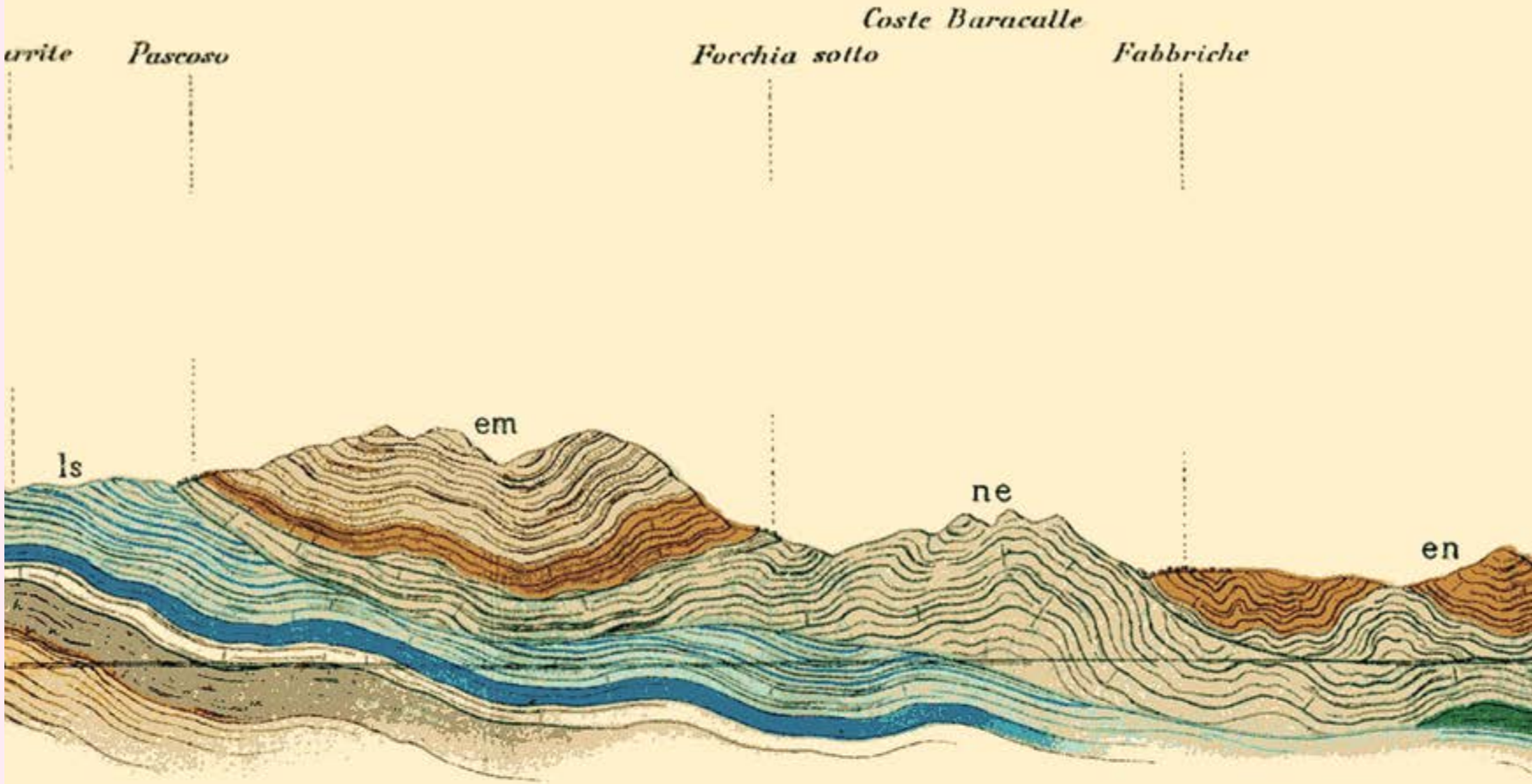
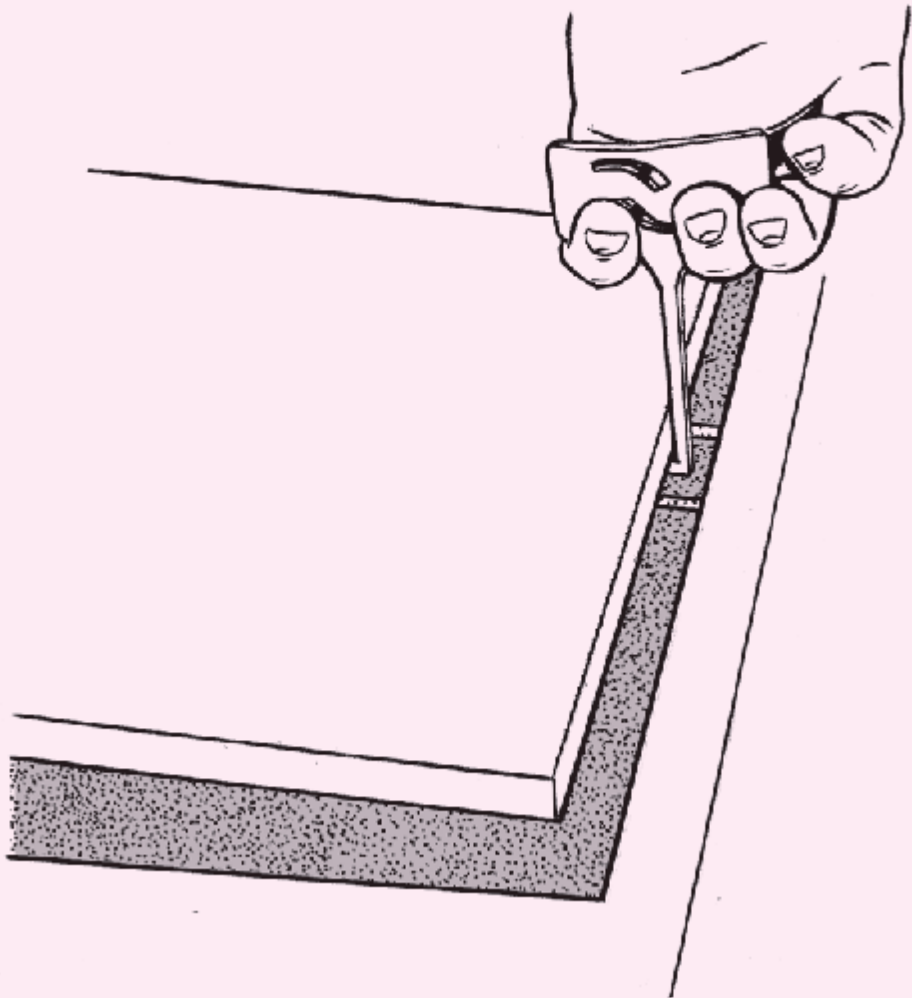
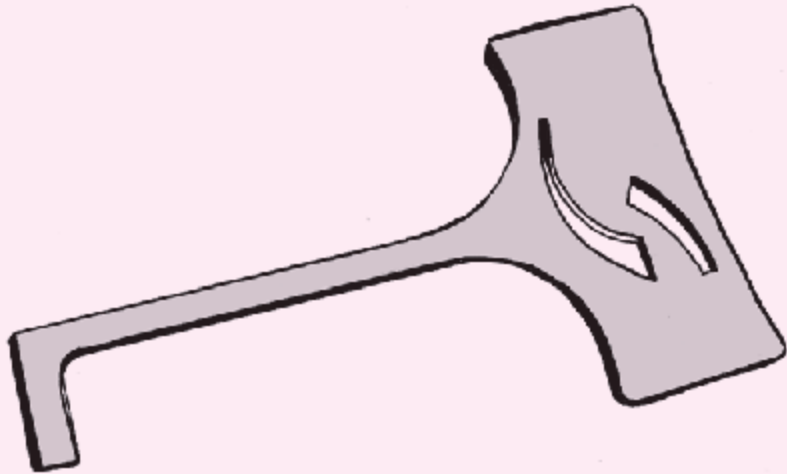



# SALVATORI

DAL 1946



NATURAL STONE



[salvatori.it](http://salvatori.it)

HEAD OFFICE  
Via Aurelia 395/E  
Querceta  
Tuscany  
ITALY  
[info@salvatori.it](mailto:info@salvatori.it)

SHOWROOMS  
Via Solferino 11  
Milan  
ITALY

Hardturmstrasse 169  
Zurich  
SWITZERLAND

26 Wigmore St  
London  
UNITED KINGDOM

Level 1, 318 Liverpool Street  
Darlinghurst, Sydney  
AUSTRALIA